

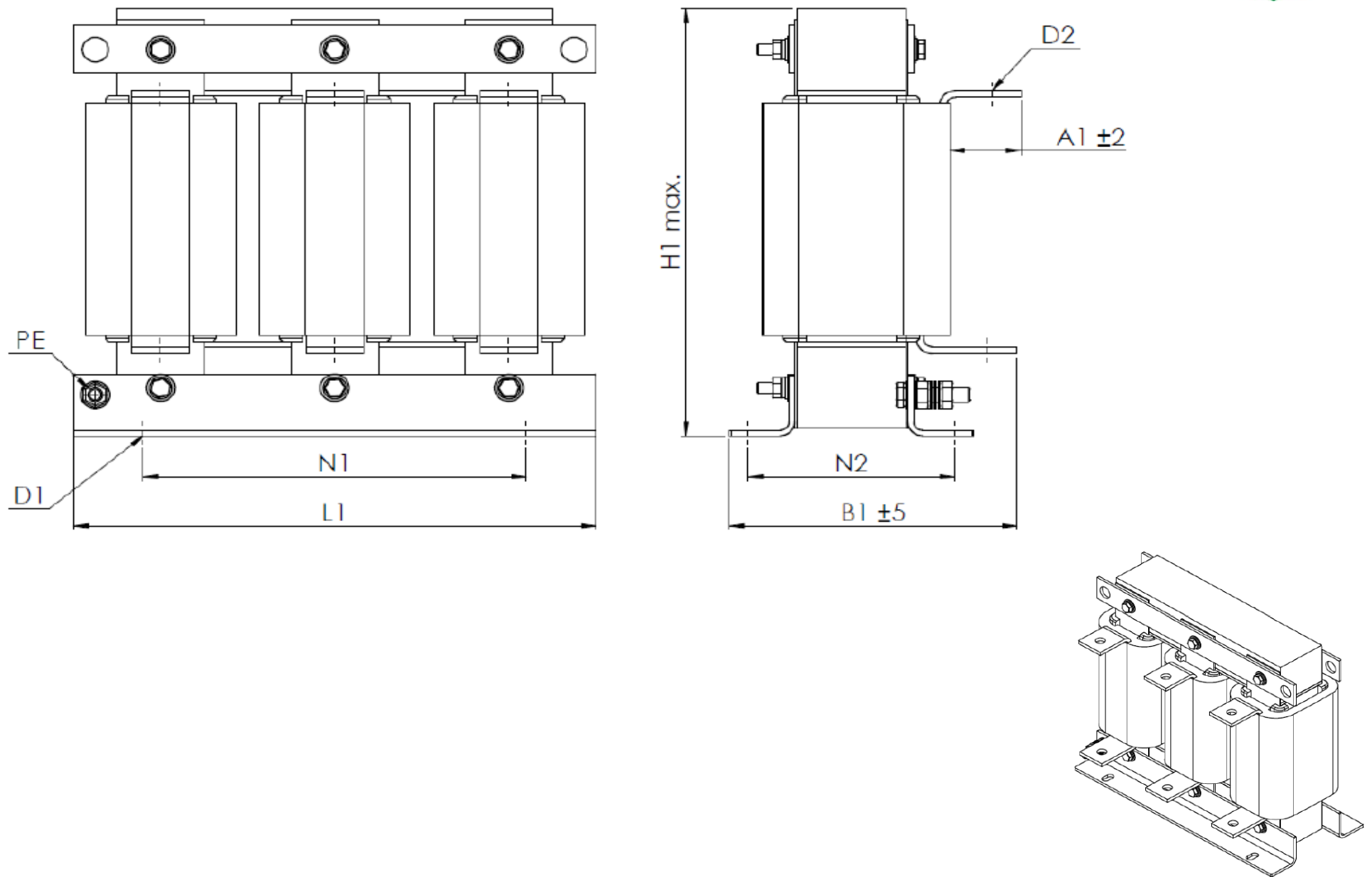

Dimension drawing:



Errors and changes reserved.

Mechanical Data:

Length L1	480,0 mm	Fixing space N1	356,0 mm	total weight	133,0 kg
Width B1	270,0 mm	Fixing space N2	168,0 mm	Weight Al	12,4 kg
Height H1	500,0 mm	Diameter D1	13 x 20 mm	Weight Cu	13,90 kg
		Diameter D2	2x ø13 mm		
		Length A1	78,0 mm	connection	60 x 10/2x ø 13
				PE	M12

Tolerance according to ISO2768-1 Tolerance class c

Electrical Data:

Rated current:	I eff.	1200 A	
linear up:		1320 A	
Voltage:	U	3x 500 V	(50 / 60 Hz)
Inductance:	L	0,0245 mH	± 10 %
DC resistance:	R	0,14 mΩ	± 10 %
Voltage drop:		uk 4%	@ 400V/ 50Hz
		uk 4%	@ 480V/ 60Hz
Power losses:		1010,0 W	
cooling system		AN	
Thermal class:		F	@ 40° C Environment
Climate class:		25/085/21	DIN IEC 68 Part 1
Max. Winding temp:		140° C	Environment +Δ9
Degree of protection:		IP 00	

Schematic:

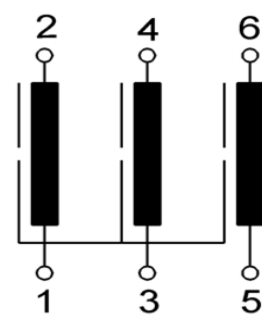

Tests

Inductance (mH)	Lo (± 10%)	bei 100Hz , 1V
High voltage	2,5 kV /50 Hz/ 60s	Winding - Winding
	2,5 kV /50 Hz/ 60s	Winding - PE
mechan. dimensions	yes	
Visual inspection	yes	

Label:

Designation: REO 3ph-line choke
 Text 1: N CNW 903 /1200/0,0245/500/50
 I[A]: 1200
 U[V]: 500
 L[mH]: 0,0245
 Text 2: AN
 Text 3: T40/F
 Terminal designation: 1 2 3 4 5 6

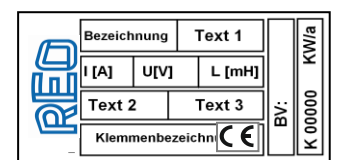

Designation:
REO 3ph-line choke
N CNW 903 /1200/0,0245/500/50

Cond.	Date	Name	Amendment

Drawing-Nr.:
BV 969336.20-00

