

# DATA SHEET

## Three Phase Induction Motor - Squirrel Cage



Customer : THE INVERTER DRIVE SUPERMARKET LTD

Product line : W22 - IE3 Premium Efficiency Multivoltage

Frame	: L80	Cooling method	: IC411 - TEFC
Insulation class	: F	Mounting	: B34T
Duty cycle	: S1	Rotation <sup>1</sup>	: Both
Ambient temperature	: -20 °C to +40 °C	Starting method	: Direct On Line
Altitude	: 1000 m.a.s.l	Approx. weight <sup>3</sup>	: 15.5 kg
Protection degree	: IP55	Moment of inertia (J)	: 0.0037 kgm <sup>2</sup>
Design	: N		

Output	0.55 kW	0.55 kW	0.55 kW	0.55 kW
Poles	6	6	6	6
Frequency	50 Hz	50 Hz	50 Hz	60 Hz
Rated voltage	220/380 V	230/400 V	240/415 V	460 V
Rated current	2.59/1.50 A	2.63/1.51 A	2.68/1.55 A	1.37 A
L. R. Amperes	13.0/7.50 A	13.7/7.85 A	14.5/8.37 A	8.49 A
LRC	5.0	5.2	5.4	6.2 x Code L
No load current	1.81/1.05 A	2.00/1.15 A	2.25/1.30 A	1.05 A
Rated speed	940 rpm	945 rpm	950 rpm	1155 rpm
Slip	6.00 %	5.50 %	5.00 %	3.75 %
Rated torque	5.59 Nm	5.56 Nm	5.53 Nm	4.55 Nm
Locked rotor torque	270 %	300 %	340 %	390 %
Pull up torque	230 %	255 %	285 %	330 %
Breakdown torque	270 %	310 %	340 %	390 %
Service factor	1.00	1.00	1.00	1.25
Noise level <sup>2</sup>	43.0 dB(A)	43.0 dB(A)	43.0 dB(A)	47.0 dB(A)
Locked rotor time (hot)	27 s	24 s	22 s	24 s
Locked rotor time (cold)	49 s	43 s	40 s	43 s
Efficiency (%)	50%	73.4	70.5	67.9
	75%	76.7	75.2	74.0
	100%	77.2	77.2	77.2
Power Factor	50%	0.49	0.45	0.42
	75%	0.63	0.58	0.55
	100%	0.72	0.68	0.64

Losses at normative operating points (speed;torque), in percentage of rated output power

Losses (%)	P1(0,9;1,0)				P2(0,5;1,0)				P3(0,25;1,0)				P4(0,9;0,5)				P5(0,5;0,5)				P6(0,5;0,25)				P7(0,25;0,25)														
	Drive end	Non drive end	Foundation loads	Max. traction	Max. compression	Load type	Load torque	Load inertia (J=GD <sup>2</sup> /4)	Drive end	Non drive end	Foundation loads	Max. traction	Max. compression	Load type	Load torque	Load inertia (J=GD <sup>2</sup> /4)	Drive end	Non drive end	Foundation loads	Max. traction	Max. compression	Load type	Load torque	Load inertia (J=GD <sup>2</sup> /4)	Drive end	Non drive end	Foundation loads	Max. traction	Max. compression	Load type	Load torque	Load inertia (J=GD <sup>2</sup> /4)	Drive end	Non drive end	Foundation loads	Max. traction	Max. compression	Load type	Load torque
	28.3	28.3	28.3	24.0	25.9	25.9	25.9	21.9	27.2	27.2	27.2	23.0	16.6	16.6	16.6	14.1	12.8	12.8	12.8	10.8	10.5	10.5	10.5	8.9	7.9	7.9	7.9	6.7											

Bearing type	Drive end	Non drive end	Foundation loads
Lubrication interval	6204-ZZ	6203-ZZ	Max. traction : 525 N
Lubricant amount	-	-	Max. compression : 677 N
Lubricant type	MOBIL POLYREX EM		Load type :-
			Load torque :-
			Load inertia (J=GD <sup>2</sup> /4) :-

Notes  
See notes on page 2.

Rev.	Changes Summary		Rev.	Checked	Date
Performed by	jhodson		1693668961		
Checked by	AUTOMATICO		Page	Rev.	
Date	08/05/2025		1 / 2	0	

# DATA SHEET

## Three Phase Induction Motor - Squirrel Cage



Customer : THE INVERTER DRIVE SUPERMARKET LTD

Product line : W22 - IE3 Premium Efficiency Multivoltage

Notes

Standards	Specification	: IEC 60034-1	Vibration	: IEC 60034-14
	Test	: IEC 60034-2	Tolerance	: IEC 60034-1
	Noise	: IEC 60034-9		

This revision replaces and cancel the previous one, which must be eliminated.  
(1) Looking the motor from the shaft end.  
(2) Measured at 1m and with tolerance of +3dB(A).  
(3) Approximate weight, subject to be changed after manufacturing process.

These are average values based on tests with sinusoidal power supply, subject to the tolerances stipulated in IEC 60034-1.

Rev.	Changes Summary	Rev.	Checked	Date
Performed by	jhodson		1693668961	
Checked by	AUTOMATICO		Page	Rev.
Date	08/05/2025		2 / 2	0

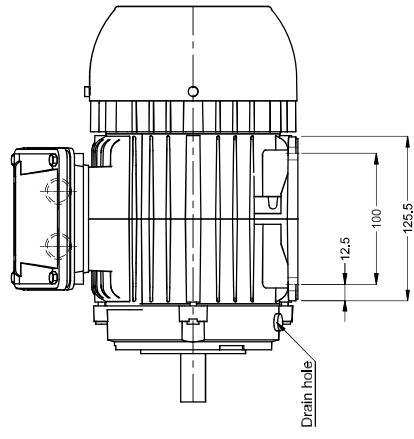
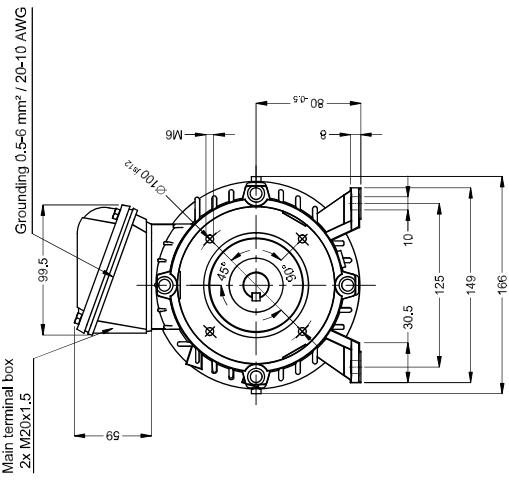
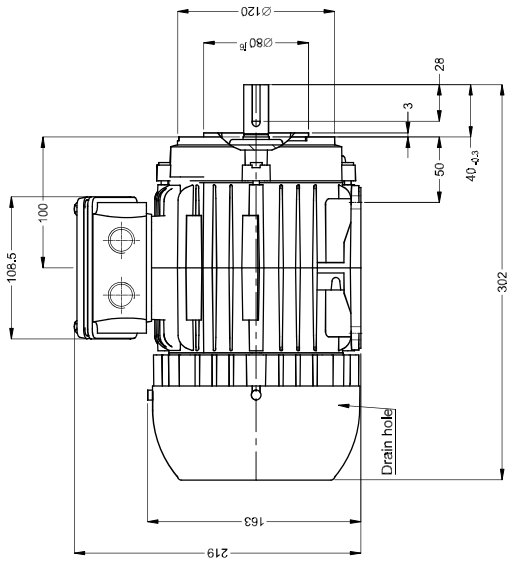

0.55 kW 06 Poles 50 Hz		THE INVERTER DRIVE SUPERMARKET LTD		A	
Scale 1 : 4					
ECM	LOC	SUMMARY OF MODIFICATIONS		PIR/BUSER	VER
EXECUTED	PIR/BUSER	THREE PH. MOTOR W22 IE3		EXECUTED	00
CHECKED		FRAME L80 IP55 TEFC		CHECKED	DATE
RELEASED				RELEASED	
REL. DATE	WEG	REDDITCH		WDD	00
				(Operational)	SHEET 1 / 1

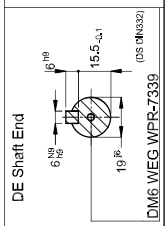

Color RAL 5009  
 Painting plan 207A  
 Mounting B34T

