

Coil	
AC	DC
A = 87	A = 115

**CWM9, CWM12 and CWM18**

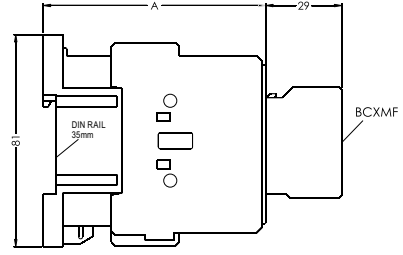
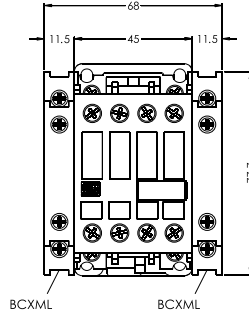
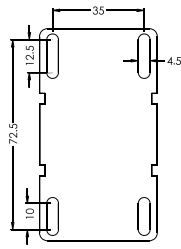

Coil	
AC	DC
A = 87	A = 117

**CWM25**

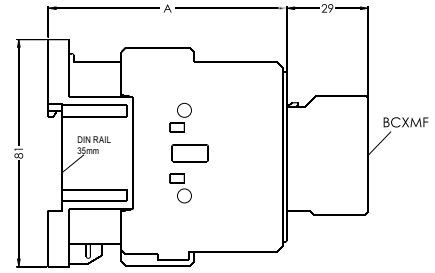
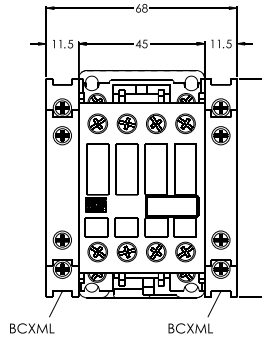
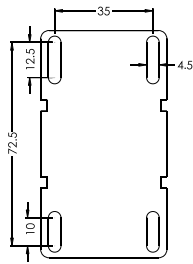

Coil	
AC	DC
A = 98	A = 118

**CWM32 and CWM40**

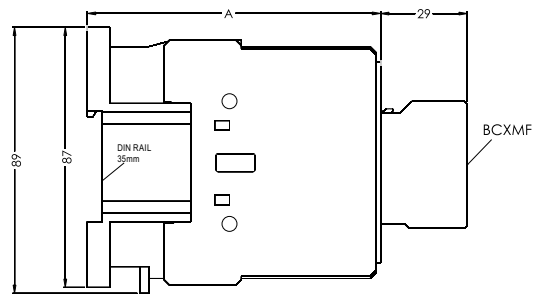
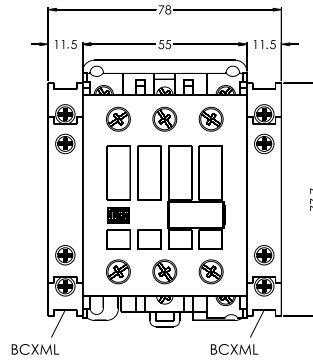
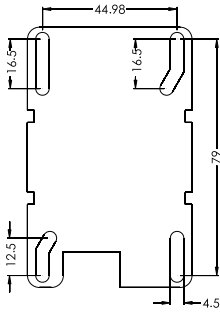

Coil	
AC	DC
A = 116	

**CWM50, CWM65 and CWM80**

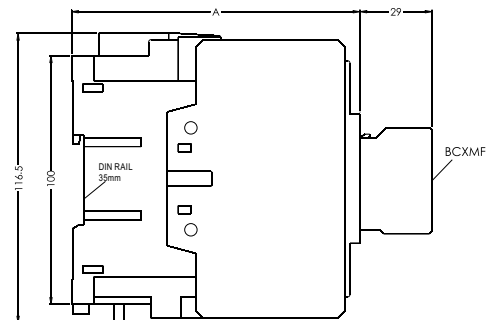
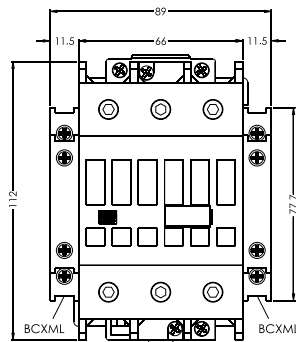
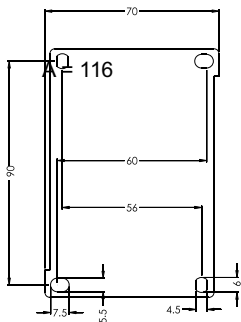

Coil	
AC	DC
A = 126	A = 126

### CWM95 and CWM105

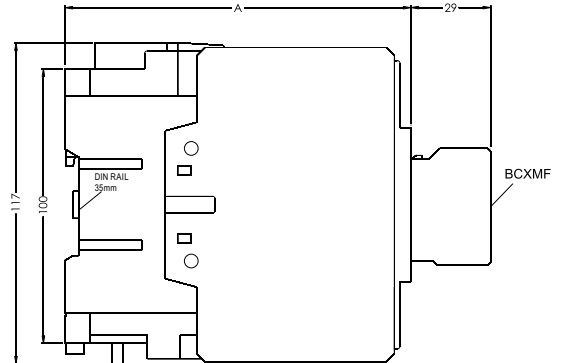
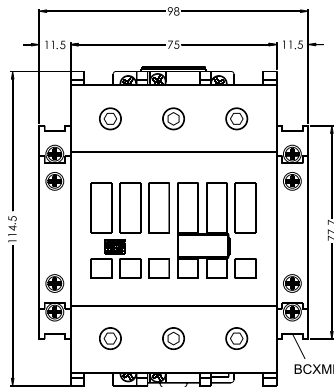
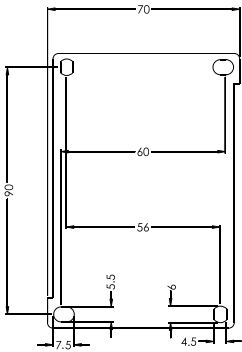

### CWM112 and CWM150

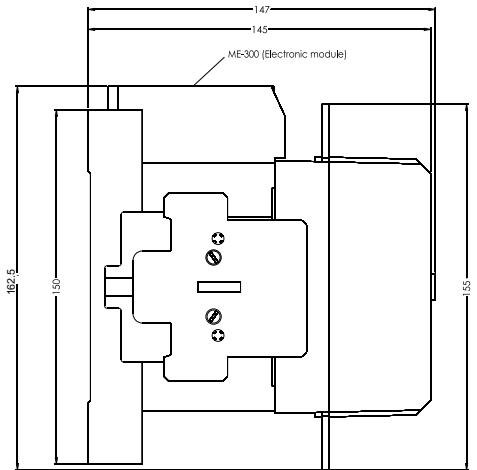
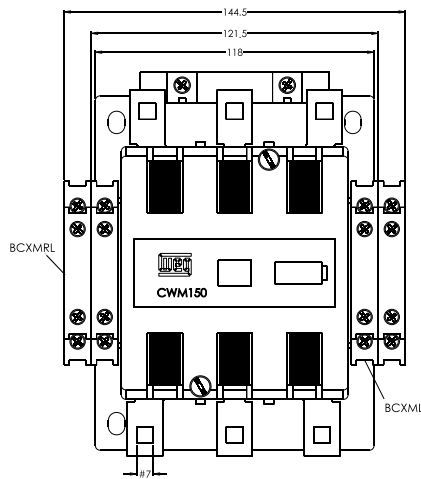
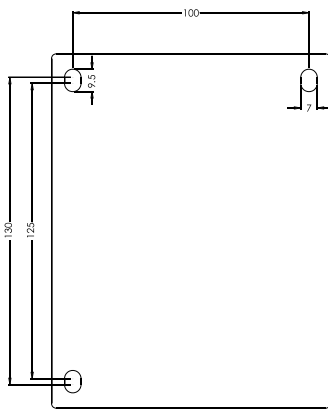

### CWM180

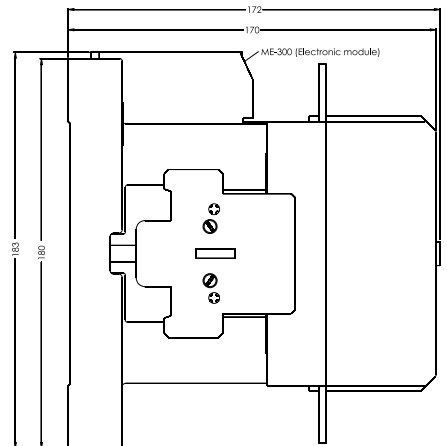
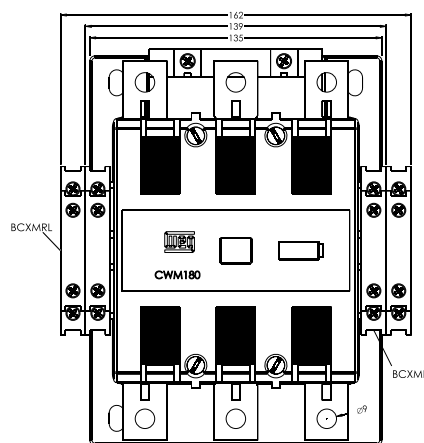
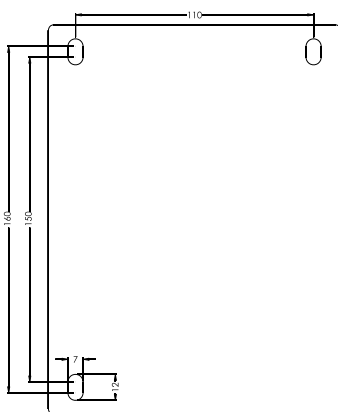

**CWM250 and CWM300**

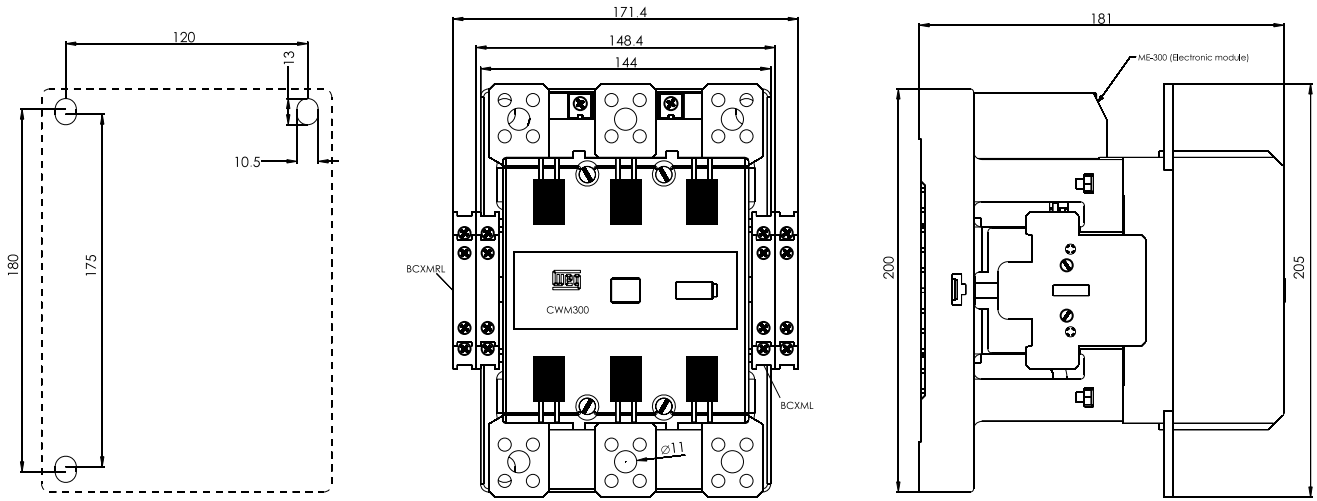

**BLIM9-105**

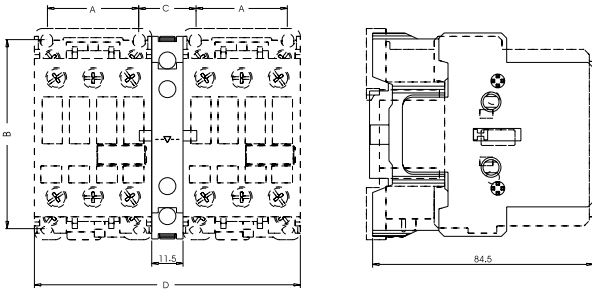

Models	A	B	C	D
CWM9...25	35	72.5	22	102
CWM32...40	45	79	22	122
CWM50...80	57	90	21	144
CWM95...105	57	90	29.8	153

**BLIM112-300**

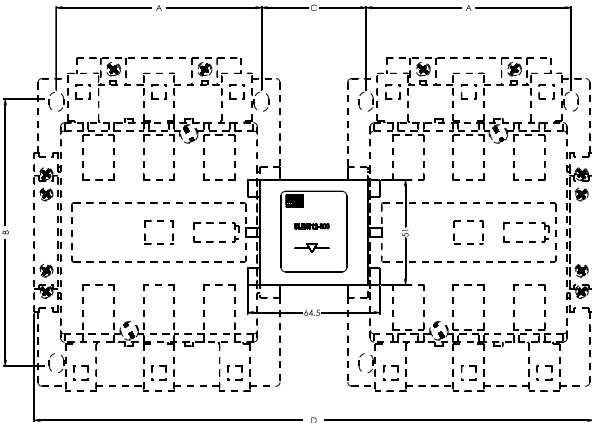

Models	A	B	C	D
CWM112...150	100	130	51	272.5
CWM180	110	160	58.5	303.5
CWM250...300	120	180	57	325.4

**CWM9...105**

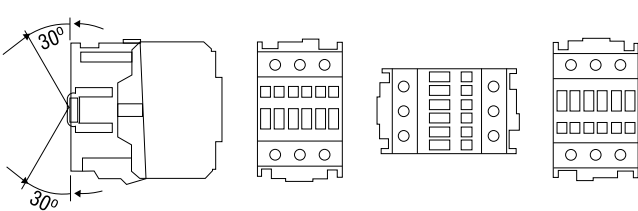

**CWM112...300**

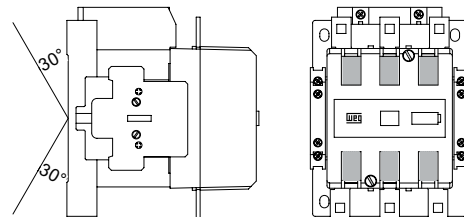

**CWME400**

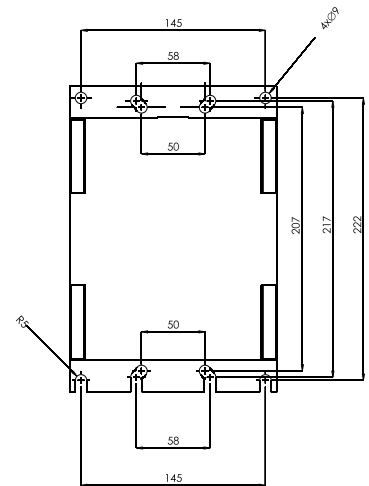
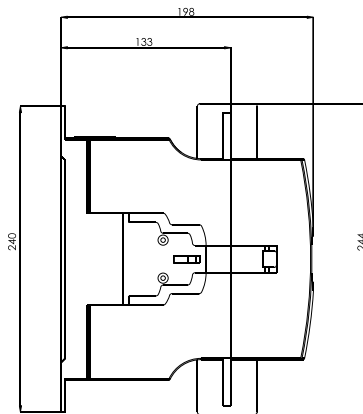
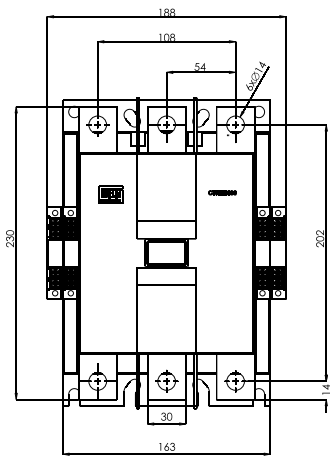

**CWME630 and CWME800**

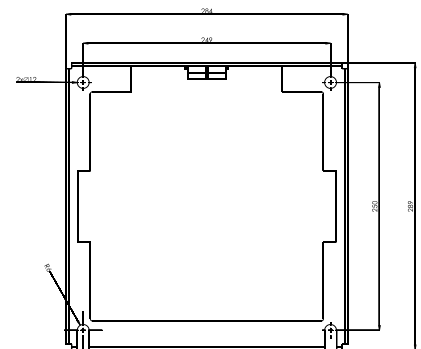
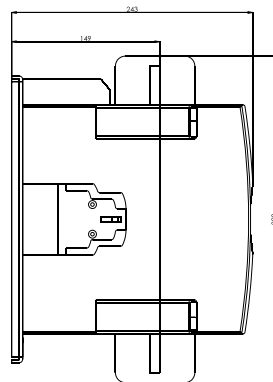
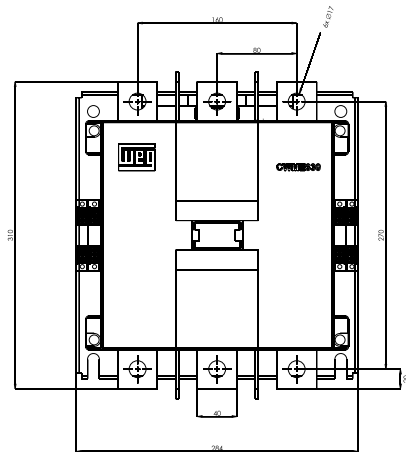

BLIM CWME400

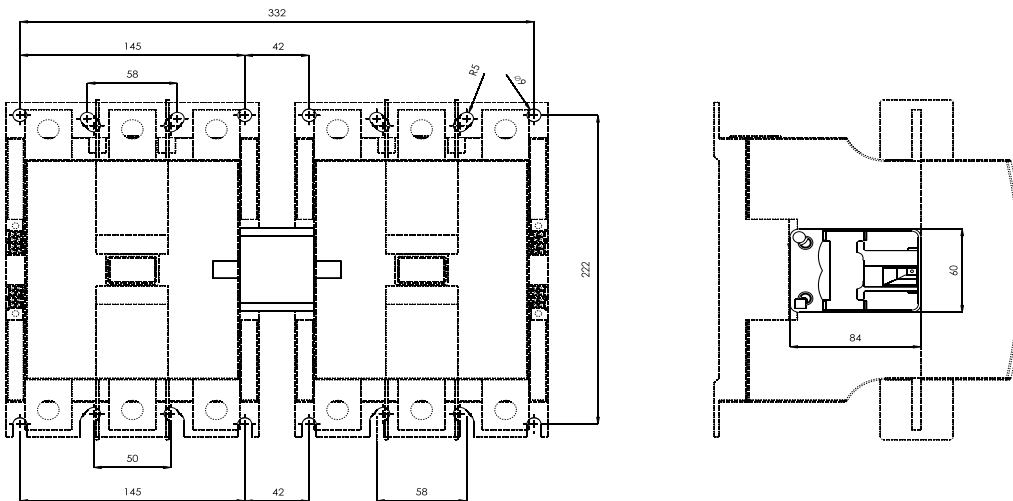

BLIM CWME800

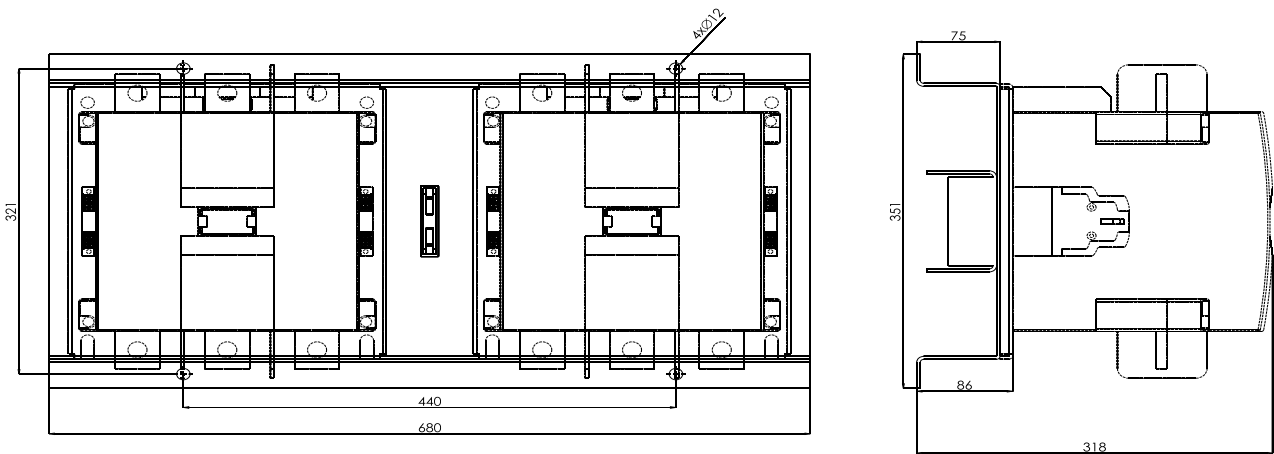

### CWME400 + BMJ

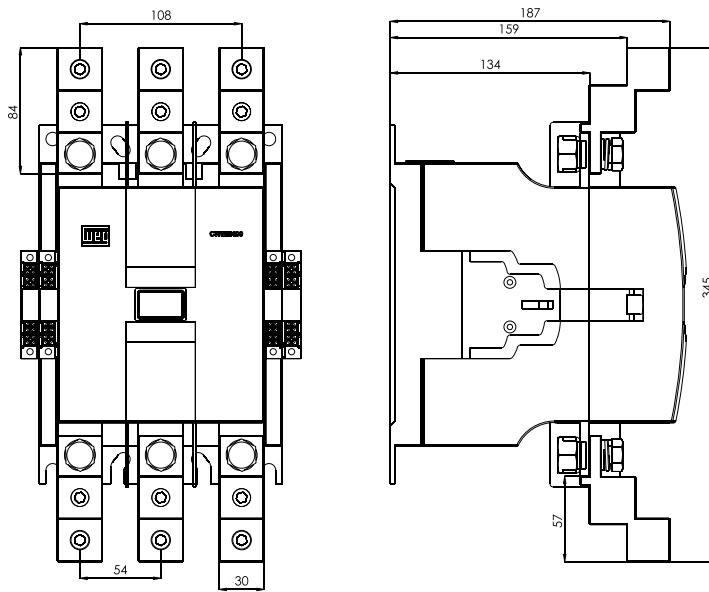

### CWME 630...800 + BMJ

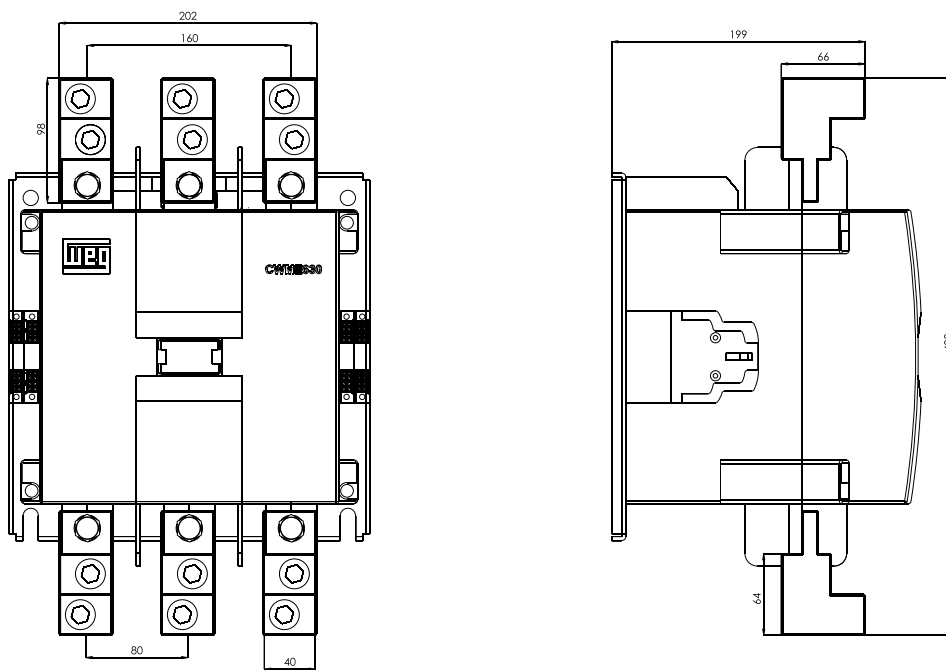

### CWME 400...800

