

# DATA SHEET



## Three Phase Induction Motor - Squirrel Cage

Customer :

Product line : Multimounting IE3 Three-Phase Product code : 13060956

Frame	: 112M	Locked rotor time	: 25s (cold) 14s (hot)
Output	: 4 kW (5.5 HP)	Temperature rise	: 80 K
Poles	: 2	Duty cycle	: S1
Frequency	: 50 Hz	Ambient temperature	: -20°C to +40°C
Rated voltage	: 400/690 V	Altitude	: 1000 m.a.s.l.
Rated current	: 7.62/4.42 A	Protection degree	: IP55
L. R. Amperes	: 58.7/34.0 A	Cooling method	: IC411 - TEFC
LRC	: 7.7	Mounting	: B34T
No load current	: 3.10/1.80 A	Rotation <sup>1</sup>	: Both (CW and CCW)
Rated speed	: 2900 rpm	Noise level <sup>2</sup>	: 62.0 dB(A)
Slip	: 3.33 %	Starting method	: Direct On Line
Rated torque	: 1.34 kgfm	Approx. weight <sup>3</sup>	: 36.2 kg
Locked rotor torque	: 250 %		
Breakdown torque	: 350 %		
Insulation class	: F		
Service factor	: 1.00		
Moment of inertia (J)	: 0.0080 kgm <sup>2</sup>		
Design	: N		

Output	50%	75%	100%	Foundation loads	
Efficiency (%)	86.5	87.5	88.1	Max. traction	: 84 kgf
Power Factor	0.69	0.80	0.86	Max. compression	: 120 kgf

Losses at normative operating points (speed;torque), in percentage of rated output power

P1 (0,9;1,0)	P2 (0,5;1,0)	P3 (0,25;1,0)	P4 (0,9;0,5)	P5 (0,5;0,5)	P6 (0,5;0,25)	P7 (0,25;0,25)
13.5	12.2	11.3	6.2	4.4	2.7	2.0

		<u>Drive end</u>	<u>Non drive end</u>
Bearing type	:	6207 ZZ	6206 ZZ
Sealing	:	Oil Seal	Oil Seal
Lubrication interval	:	-	-
Lubricant amount	:	-	-
Lubricant type	:	Mobil Polyrex EM	

Notes

This revision replaces and cancel the previous one, which must be eliminated.

- (1) Looking the motor from the shaft end.
- (2) Measured at 1m and with tolerance of +3dB(A).
- (3) Approximate weight subject to changes after manufacturing process.
- (4) At 100% of full load.

These are average values based on tests with sinusoidal power supply, subject to the tolerances stipulated in IEC 60034-1.

Rev.	Changes Summary	Performed	Checked	Date
Performed by		Page		Revision
Checked by		1 / 1		
Date	12/02/2025			

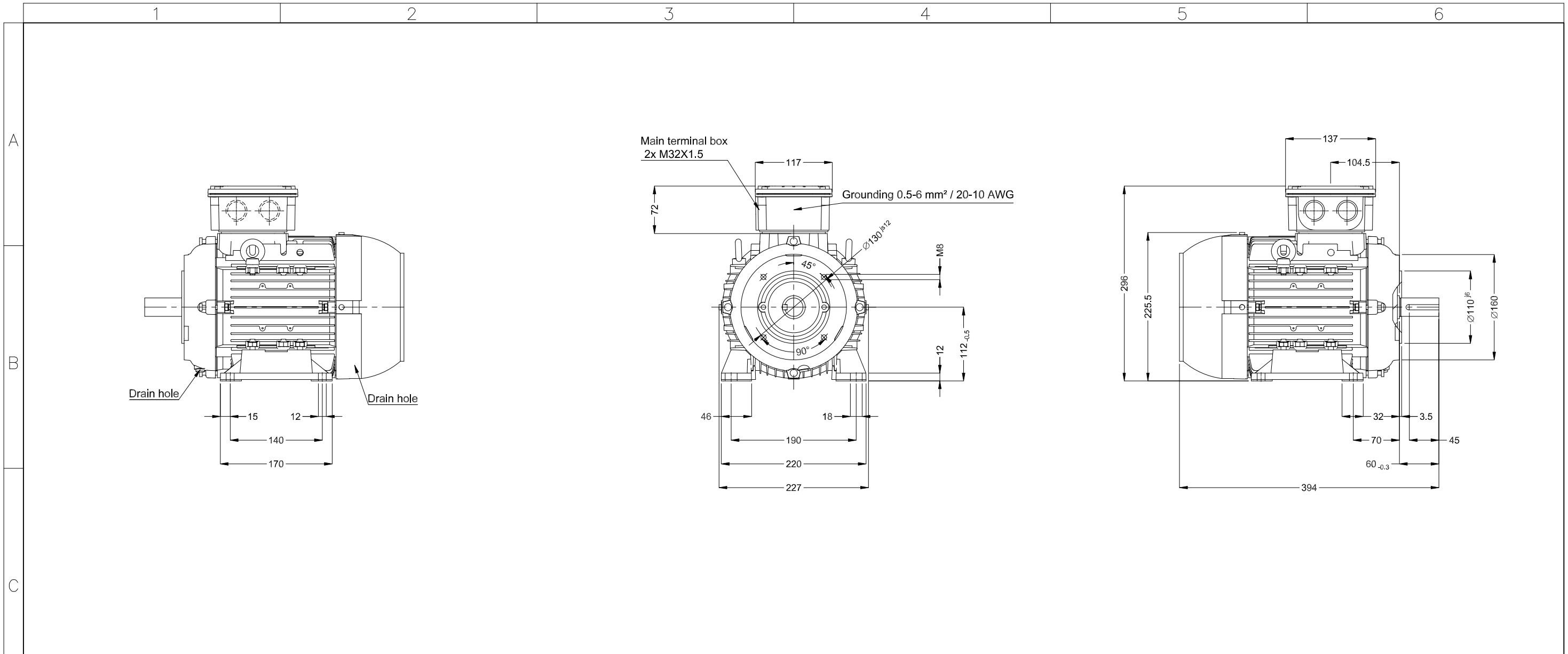

D			4 kW 02 Poles 50 Hz		A
			Scale 1 : 6		
E			HYBRISUSER		00
	ECM	LOC	SUMMARY OF MODIFICATIONS	EXECUTED	CHECKED
	EXECUTED	HYBRISUSER	THREE PH. MOTOR MULTIMOUNTIN TOP PREM. EFF.		
	CHECKED		FRAME 112M IP55 TEFC		
			RELEASED		
			REL. DATE		

- Sealing - oil seal ring
- Bearing cap
- Color RAL 5009
- Painting plan 207A
- Mounting B34T

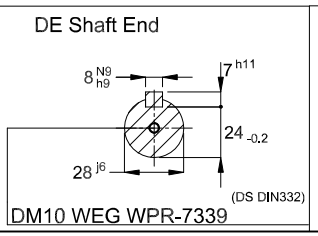

EXECUTED		HYBRISUSER		THREE PH. MOTOR MULTIMOUNTIN TOP PREM. EFF.		<b>PREVIEW</b> WDD   00		
CHECKED				FRAME 112M IP55 TEFC		SHEET 1 / 1		
RELEASED								
REL. DATE								